



Guide for International Students



Akita University

Akita University

Akita University is a comprehensive national university consisting of both undergraduate and graduate programs. Formerly known as Akita Normal School, Akita Youth Normal School, and Akita Mining College, it was later established as Akita University in 1949.

Student Figures (as of May 1, 2023)

◆ Students: 5,196 (Undergraduate 4,324, Graduate 872)

◆ International Students: 263 (Undergraduate 142, Graduate 121) *The figure includes degree seeking international students.

Faculties	Total number admitted	International Students		
		Degree-seeking	Non Degree-seeking	Total
International Resource Sciences	516	11	5	16
Education and Human Studies	888	8	25	33
Medicine	1,213	1	0	1
Engineering Science	1,707	84	8	92
Total	4,324	104	38	142

Graduate Schools	Total number admitted	International Students		
		Degree-seeking	Non Degree-seeking	Total
International Resource Sciences	157	72	1	73
Education	42	0	0	0
Medicine	229	3	1	4
Engineering Science	424	44	0	44
Advanced Health Care Engineering	20	0	0	0
Total	872	119	2	121

Overseas Partner Universities (as of May. 1, 2023)

Inter-University Agreements

● 73 Universities (35 Countries and Regions)

Countries/Regions	Universities	Student Exchange Agreement	Countries/Regions	Universities	Student Exchange Agreement
Asia	India	Indian Institute of Technology Madras ●	Asia	Mongolia	Mongolian University of Science and Technology ●
		Vellore Institute of Technology ●			Mongolian State University of Education ●
		Institut Teknologi Bandung ●			New Mongol Academy -
	Indonesia	Trisakti University -	Africa	Kenya	Kenyatta University ●
		Gadjah Mada University -		Botswana	Botswana International University of Science and Technology ●
		Universitas Pertamina ●			University of Botswana ●
	Korea	Padjadjaran University -		Mozambique	Eduardo Mondlane University ●
		Hanbat National University ●		Republic of South Africa	Tete Polytechnic Institute for Higher Education ●
		Wonkwang University ●	Oceania	Zambia	The University of the Witwatersrand -
	Thailand	Kangwon National University ●		Australia	University of Zambia -
		Chulalongkorn University ●			Griffith University -
		Suranaree University of Technology ●		Papua New Guinea	Curtin University -
	Taiwan	Chiang Mai University -			Papua New Guinea University of Technology -
		Lungwa University of Science and Technology ●	North America	USA	St.Cloud State University ●
		National Taiwan University ●		Canada	University of Guam ●
	China	National Cheng Kung University ●			Memorial University of Newfoundland ●
		Chang Jung Christian University ●	Middle East	Chile	University of Santiago ●
		Heilongjiang University ●		Israel	University of Haifa ●
	Philippines	Central South University ●		UAE	United Arab Emirates University -
		Liaoning Technical University ●	Europe (including NIS countries)	Italy	University of Cagliari ●
		Dalian Minzu University ●			University of Ferrara ●
	Vietnam	Lanzhou University ●		Kazakhstan	D. Serikbayev East Kazakhstan State Technical University ●
		Jilin University ●			Nazarbayev University -
		Northeastern University ●		Kyrgyzstan	Kyrgyz State University of Geology, Mining and Natural Resources Development named after Academician U. Asanaliyev -
	Malaysia	Donghua University ●		Sweden	Luleå University of Technology ●
		Beihua University ●			Mining-metallurgical Institute of Tajikistan -
		Jiaxing University ●		Germany	Freiburg University of Mining and Technology ●
	Myanmar	Northwest Normal University ●		Finland	Lapland University of Applied Sciences ●
		University of the Philippines Dili ●			Kajani University of Applied Sciences ●
		University of the Philippines Manila ●		Belarus	Lapland University of Applied Sciences ●
		University of the Philippines Los Baños ●		Poland	Belarusian State Medical University -
		Hanoi University of Science and Technology ●			Cracow University of Economics ●
		University of Transport and Communications ●		Romania	University of Bucharest ●
		University of Malaya ●			Banja Luka University -
		University of Yangon -		Bosnia and Herzegovina	University of East Sarajevo -
				Belgium	VIVES University of Applied Sciences -

Inter-Faculty Agreements

● 38 Faculties (22 Countries and Regions)

Faculties	Countries/Regions		Faculties, Universities	Student Exchange Agreement	
Graduate School of International Resource Sciences	Asia	Indonesia	Faculty of Engineering, Hasanuddin University Faculty of Geological Engineering, Universitas Padjadjaran	●	
		Thailand	Faculty of Mineral Technology Universitas Pembangunan Nasional "Veteran" Yogyakarta	-	
	Africa	Sudan	Faculty of Science, Kasetsart University Faculty of Earth Sciences Faculty of Marine Sciences and Fisheries, Red Sea University	-	
		Serbia	Technical Faculty in Bor, University of Belgrade National Institute of Chemistry, Technology and Metallurgy, University of Belgrade	-	
	Europe (including NIS countries)	Poland	The AGH University of Science and Technology Uzbek-Japan Innovation Center of Youth (UJICY)	-	
		Uzbekistan	University of Geological Sciences of Uzbekistan/ Uzbek-Japan Innovation Center of Youth (UJICY)	-	
		Tajikistan	Navoi State Mining Institute Centre of Innovative Development of Science and New Technologies, National Academy of Sciences of Tajikistan	-	
	North America	Canada	Institut National de la recherche scientifique, Université du Québec Faculty of Engineering, University of Alberta	-	
	Faculty of Education and Human Studies	Asia	Korea	Korean Language School of Sungkonghoe University	-
	Graduate School of Medicine	Asia	China	Beijing Hospital, Ministry of Health	-
Singapore			Alice Lee Center for Nursing Studies, Yong Loo Lin School of Medicine, National University of Singapore	●	
Thailand		School of Nursing Suranaree University of Technology	●		
France		The Faculty of Medicine of Lille 2 University	●		
Europe		Belgium	Bachelor in Nursing & Bachelor in Occupational Therapy VIVES University of Applied Sciences	●	
		North America	USA	John A. Burns School of Medicine, University of Hawaii at Manoa MD Anderson Cancer Center, University of Texas	-
Akita University Hospital	Asia	China	The First Hospital of Lanzhou University	-	
Graduate School of Engineering Science	Asia	Taiwan	College of Engineering Minghsin University of Science and Technology Department of Precision Instruments and Mechanology, Tsing Hua University	●	
		China	Department of Chemistry, Tsing Hua University School of Materials Science and Engineering, Tongji University	●	
		India	Shanghai Key Lab of D&A for Metal Functional Materials, Tongji University The CSIR-Indian Institute of Chemical Technology	-	
		Malaysia	Malaysia Japan International Institute of Technology, Universiti Teknologi Malaysia	-	
		Thailand	Thai-Nichi Institute of Technology	-	
		Africa	Tunisia	Faculty of Technology, University of Sfax	●
	Oceania	New Zealand	Faculty of Design and Creative Technologies, Auckland University of Technology (AUT)	-	
	North America	USA	Montana College of Mineral Science and Technology	-	
	Europe	Hungary	Faculty of Informatics, University of Debrecen	-	
		Slovakia	Faculty of Mathematics, Physics and Informatics, Comenius University	-	
Great Britain		Faculty of Engineering Science, Aston University	-		
Center for Regional Development	Asia	China	Shanghai Key Lab of D&A for Metal Functional Materials, Tongji University	-	

※Student Exchange based on Inter-Faculty Agreements are vary by faculty.

春 Spring

夏 Summer

Akita

An abundance of nature and traditional culture changing along with the four seasons.

Akita Prefecture is located in northern Honshu on the Sea of Japan. It offers a rich natural environment including the Shirakami mountain range (a World Heritage site), Lake Tazawa (the deepest lake in Japan), Hachimantai, and Oga Peninsula, where the four seasons can be distinctly experienced and enjoyed. Akita's seasonal festivities include the Sakura (cherry blossom) festivals in spring, Kanto festival (one of the three great Tohoku festivals) in summer, viewing fall foliage in autumn, and a variety snow sports (skiing, snowboarding, etc.) in winter.

The university's campus is located in Akita City with a population of 300,000. It is the capital of Akita Prefecture, and is also the prefecture's political and economic center. It is convenient in terms of transportation and has a lower cost of living than Tokyo. Students find the city a very suitable environment for daily life.

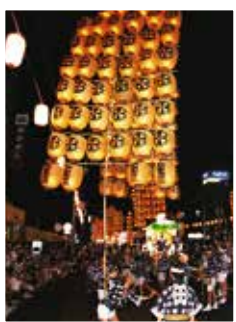

Kanto Festival

Held every year from August 3 – 6 in Akita City. The largest Kanto Pole is 12 meters in height and weighs approximately 50 kgs. Balancing the giant Kanto using their hands, lower back and forehead, the dancers display their skills while competing with one another. The university also has a kanto team.



Namahage Event

An ethnic tradition originating from the Oga Peninsula, held on New Year's Eve. Namahage are said to be messengers of the gods.



Lake Tazawa

Japan's deepest lake, located in the city of Semboku (Maximum depth 423.4 m). It is approximately 1 hour away from the university and it is a great place to enjoy canoeing or rafting.



Kiritampo

Kiritampo, part of Akita's regional cuisine, is rice that has been mashed and wrapped around a skewer, then toasted and finally cut into easy-to-eat pieces. When it is added to a hot pot with chicken, vegetables, mushrooms, etc. it is called "Kiritampo Nabe" (Kiritampo hot pot).



Onsen (hot springs)

Akita has many hot springs, the most famous being Nyuto Hot Spring Village and Tamagawa Hot Spring. This photo features the open-air bath at Nyuto Hot Spring Village.

秋 Autumn

冬 Winter



Undergraduate

Interview Movies with Undergraduate Students

Faculty of International Resource Sciences



English Sub



Chinese Sub

Japan is facing problems associated with the allocation of the earth's resources such as economic minerals and petroleum resources. With these challenges in mind, the faculty of International Resource Sciences was launched in 2014 with the purpose of developing global human resources to address these problems.

We provide a unique education experience in resource sciences by offering specialized education in English, overseas resource science fieldwork and an interdisciplinary approach to resource science education.

The faculty consists of 3 courses. "Resource Policy and Management" in which students study natural resources from the perspective of humanities and social sciences, including political science and economics, business and international cooperation with resource-rich countries; "Earth Resource Science," in which students study global-scale natural phenomena, earth history, materials comprising the earth, and their distribution and exploration that produce resources; and the "Earth Resource Engineering and Environmental Science," in which students study specialized fields related to resource development and production technology, recycling and refining technology, and environmental conservation, all in harmony with the global environment.

Department of International Resource Sciences

Resource Policy and Management

Earth Resource Science

Earth Resource Engineering and Environmental Science

Faculty of Education and Human Studies



English Sub



Chinese Sub

The Faculty of Education and Human Studies consists of the Department of School Education and the Department of Regional Studies and Humanities. The Department of School Education focuses on teacher training with particular emphasis on elementary education, which includes pre-school and junior-high school education. The goal of the Department of Regional Studies and Humanities is to produce talented graduates who can play a central role in their local communities in areas such as the local economy, cultural development, and community development and revival.

Department of School Education

Course for Compulsory School Teachers

Course for English Language Teachers

Course for Science and Mathematics Teachers

Course for Special Needs Education Teachers

Course for Child Development and Education

Department of Regional Studies and Humanities

Program in Regional Studies

Program in International Culture Studies

Program in Psychological Studies

Faculty of Medicine



English Sub



Chinese Sub

We are training talented students who are able to maintain an international perspective and who can contribute to people's health and welfare. We do this by first making sure that our students have a broad educational background rooted in the humanities. Our students are flexible and adaptable allowing them to adjust accordingly to the ever advancing fields of medicine and healthcare. Over time our students develop an ability to solve problems, and a firm understanding of medical and health sciences. Other than working as a medical professional in a clinical setting, these programs also offer the possibility of on into graduate school to become a researcher or instructor, or any number of other advanced specialists in the medical field continuing.

School of Medicine

School of Health Sciences

Nursing major

Physical Therapy major

Occupational Therapy major

Faculty of Engineering Science



English Sub



Chinese Sub

The Faculty of Engineering Science has been restructured, placing a greater emphasis on integrating "the sciences", which seek to understand nature through the process of refining and producing resource materials with "engineering", which finds practical applications for refined resources that benefit society. Based on those terms, the Faculty aims to develop talented graduates with logical thinking skills and the ability to realize and implement innovative ideas.

The Faculty consists of 4 departments, which consists of 8 separate courses, as listed below.

Department of Life Science

Life Science Course

Department of Materials Science

Applied Chemistry Course

Materials Science and Engineering Course

Department of Mathematical Science and Electrical-Electronic-Computer Engineering

Mathematical Science Course

Electrical and Electronic Engineering Course

Human-Centered Computing Course

Department of Systems Design Engineering

Mechanical Engineering Course

Civil and Environmental Engineering Course



Graduate

Graduate School of International Resource Sciences

The Graduate School of International Resource Sciences aims to study global resource problems and stimulate critical and creative thinking to develop strategies to help solve problems of energy and resource development, production and distribution. We strongly encourage international students to apply for this program. All lectures are conducted in English, and research activities mainly consist of discussions in English. You can take a course in English in order to get a degree.

Master's Degree Program

Earth Resource Science Earth Resource Engineering and Environmental Science

Doctoral Degree Program

Geosciences, Geotechnology, and Materials Engineering for Resources

Graduate School of Medicine

The Graduate School of Medicine aims to train excellent researchers and highly specialized medical staff who possess an international perspective, and who can promote the most advanced research in medicine, medical, and life sciences, all of which contribute to the development of human health and welfare.

Master's Degree Program

Medical Science

Master's Degree Program

Health Sciences Nursing Science Rehabilitation Science

Doctoral Degree Program

Medicine

Doctoral Degree Program

Health Sciences Women and Children's Development Support Sciences Lifestyle Function and Health Support

Graduate School of Engineering Science

The Graduate School of Engineering Science aims to nurture human resources who can systematically acquire advanced specialized knowledge and skills on a fundamental basis, and who can contribute to regional development and the sustainable growth of Japan based on a flexible approach, international perspective and solid ethics.

Master's Degree Program

Life Science
Materials Science
Mathematical Science and Electrical-Electronic-Computer Engineering
Systems Design Engineering
Cooperative Major in Life Cycle Design Engineering

Doctoral Degree Program

Integrated Engineering Science

The Doctoral Degree Program provides a separate English course in which the entire curriculum is conducted in English.

Graduate School of Advanced Healthcare Engineering

The Graduate School of Medicine, the Graduate School of Science and Engineering, and the "Advanced Research Center for Geriatric and Gerontology, Akita University (ARGG)" will collaborate to establish an educational curriculum that covers health care in daily life, medical diagnosis, treatment, and prognosis for people living in super-aging societies, with the objective of solving problems that arise in the field by utilizing ICT and data science. The purpose of this program is to contribute to a vibrant super-aging society by solving problems that arise in the field through the use of ICT and data science, and to develop human resources who can disseminate the results of their research on new devices and systems to the world.

Master's Degree Program

Engineering



Admissions

1. Self-funded International Students

Category	Purpose	Notes	Application
Undergraduate Students	Degree Seeking (Bachelor)	Must earn required credits and be enrolled at the University for minimum of 4 years (6 years for medical students).	See the attached "Selection Criteria for Self-funded International Students"
Graduate Students	Degree Seeking (Master/Doctorate)	Take required courses, pass final exams, and pass thesis review. Master's Degree Required to be enrolled in one of the following programs for a minimum of 2 years: Graduate School of International Resource Sciences Program Graduate School of Medicine Program, Graduate School of Engineering Science Program, Graduate School of Advanced Healthcare Engineering Program.	See Graduate Schools' Websites
		Doctoral Degree Health Sciences: 3 years minimum enrollment. Medicine: 4 years minimum enrollment. International Resource Sciences, Engineering Science: 3 years minimum enrollment.	
Exchange Students Short-term Exchange Students (Undergraduate, Graduate) Short-term Research Students (Graduate)	Non-degree Seeking	Only available for students enrolled in our partner universities with international student exchange agreements. Required to attend programs for 1 semester or 2 semesters. Undergraduate Credits and transcript of results issued. * Course requirements for completion: 8 classes or more per week (1 class = 90 minutes) and credits Graduate Certificate of course completion issued.	About 5 months before the start of the program Applicants for April admission: around November Applicants for October admission: around May *Refer to the website for international exchange for details.
Non-degree Study Students	Non-degree Seeking	Required to attend regular courses and obtain required grades. * Minimum enrollment of 10hours per week is required for obtaining a student visa. (However, excluding Faculty of Education and Human Studies)	Inquire directly to each Faculty and Graduate School
Research Students	Preparing for Graduate School	Required to be engaged in research of specific themes under the supervision of an approved advisor.	

2. Japanese Government Sponsored International Students

*See the Ministry of Education, Culture, Sports, Science and Technology website for more information.

Category	Purpose	Notes	Application
Undergraduate Students	Degree Seeking (Bachelor)	Same as "1. Self-funded Undergraduate Students" (above).	Embassy recommendation (apply through overseas Japanese diplomatic office) or University recommendation (consult with your university or graduating university) necessary.
Graduate Students (Research Students)	Degree Seeking (Master/Doctorate)	Same as "1. Self-funded Graduate Students" (above).	
	Non-degree seeking	Same as "1. Self-funded Research Students" (above).	
Japanese Studies Students, "Nikken-sei"	Non-degree Seeking	Complete a 1-year program to improve Japanese language skills and understanding of Japan and its culture.	Embassy recommendation necessary. (apply through overseas Japanese embassies or consulates)
Teacher Training Students, "Kyoken-sei"	Non-degree Seeking	Only applicable for in-service teachers or teachers currently undergoing teacher training in their home country. Taking a Japanese language course is compulsory and students must be able to research under supervision in Japanese.	

*Sufficient Japanese language proficiency is necessary to study at Akita University as most lectures and programs are provided in Japanese.



Financial Support

(1) Deferral of university fees (for privately financed international students)

This system enables students who are considered to have excellent academic prospects but have difficulties paying their entrance fees on time for financial reasons to defer their payments. Students must apply for permission to defer payment prior to beginning their studies at the University.

For details, see "University Fees/Living Expenses/Scholarships" (https://www.akita-u.ac.jp/honbu/life/li_lifesupport.html) or "Akita University Entrance Examination Guidelines for Privately Financed International Students" (to be announced in mid-September) on the Akita University website.

(2) Scholarship *Scholarships are awarded competitively to students after a review process.

a) International Student Scholarship Program

Program for self-funded international students (excluding exchange students) provided through Japan Student Services Organization (JASSO)

b) Privately Financed Scholarships

Various scholarship programs for self-funded international students (excluding exchange students)

c) Akita University (Scholarship for New University Entrants)

Students who are facing financial difficulties (including self-funded international students) are eligible for a grant payment of up to a maximum of 100,000 yen.



Employment Support for International Students

At Akita University, many international students have found employment at Japanese companies. The Employment Promotion Section of the Student Support Center supports international students who wish to find employment in Japan, so please feel free to contact us if you have any concerns or concerns.

<Example of employment support>

- Holding employment guidance for international student
- Receiving employment consultations (resume correction and interview practice are also available)
- Information about employment events for international students held on and off campus, such as joint company information sessions

<Student voice>

When I first started looking for a job, I was hesitant about interviewing because I was worried about writing Japanese. However, the staff in charge of employment promotion corrected my entry sheet and helped me practice interviews. Also, he enthusiastically answered my questions. It gave me a lot of confidence and helped me find the right job.



Student Exchange Programs

Only available for international students enrolled in partner universities with an Agreement on Student Exchange.

1 Akita University Academic Japanese Program (AUAJ)

In principle, this is a program for students who have majored in Japanese Language or Japanese Language Education, and have a Japanese language proficiency greater than or equivalent to the Japanese-Language Proficiency Test (JLPT) level N2. The program aims to provide students with advanced Japanese language skills, expertise, and motivation for various academic activities.

Program Length: 2 semesters (April to February, or October to August)

2 Akita University Program for Solving of the Regional Problem (AUSR)

International students will take active roles in exchange activities centered around local events alongside local residents while studying Japanese language and their specialized fields of study in order to meet the aims of the people from Akita. In the second half of the program, students will create and conduct projects which contribute to regional revitalization through activities in which they will cooperate with Japanese students and the local residents.

Program Length: 1 semester or 2 semesters (starts in April or October)

3 Akita University General Program (AUGP)

A flexible program for students who do not wish to undertake AUAJ or AUSR. Students can participate in classes of their own choice for either 1 or 2 semesters.

Program Length: 1 semester or 2 semesters (starts in April or October)



Facilities



Cafeteria

Providing meals from 8:00 a.m. to 7:30 p.m. on weekdays.



Library

Ample study space.



Convenience Store

Light meals such as bentos and drinks are available here.



Multicultural Lounge

International students are free to use this space. It's open on weekdays from 8:30 a.m. until 5:00 p.m.



Book Store

You can purchase textbooks, other books or stationery items here.



International Affairs Division

General advice and guidance are provided for international students. If you ever need some assistance, please come in for a consultation any time.

Health Center

Staffed with doctors, nurses and counselors.



Campus Life



Orientation for International Students

The orientation provides information on administrative procedures at the city hall, the bank, and important tips for daily life in Japan. In addition, a campus tour is provided to introduce you to various facilities.



Orientation for
International
Students
Entrance ceremony

4
APRIL

5
MAY

6
JUNE

7
JULY

8
AUGUST

9
SEPTEMBER

Graduation
ceremony

First semester classes (April to August)

There are so many
fun events!

Farming Tour

In this event, participants experience farming activities and homestay at the local farmer's house.

Let's wear Yukata and join "Japanese tea ceremony"

Participants wear "Yukata" and join Japanese traditional tea ceremony event.



June : Let's wear Yukata and join
"Japanese tea ceremony"

October : Farming Tour





August : Kanto Festival



Orientation for
International
Students

10
OCTOBER

11
NOVEMBER

12
DECEMBER

1
JANUARY

2
FEBRUARY

3
MARCH

Second semester classes (October to February)

Graduation
ceremony

Support system during study abroad

Supervisor in charge

All international students will be assigned a supervisor. We provide guidance and advice regarding studies, further education, and daily life.

Tutor system

You will be supported by students called tutors who will help you study at university and live your daily life without any inconvenience.

(Support example)

- Guidance on your Japanese language
- Support for class preparation and review
- Research guidance advice
- Accompaniment to city hall etc. for various procedures
- Shopping for daily necessities

Skiing tour

Skiing tour for international and Japanese students. Instructors will help participants who do not have experience.



February : Skiing Tour



(1) Tuition (AY2023 enrolled students)

Category	Tuition Fee	Admission Fee	Examination Fee
Undergraduate Students	¥535,800 per year *	¥282,000	¥17,000
Graduate Students	¥535,800 per year *	¥282,000	¥30,000
Short-term Exchange Students Short-term Research Students	Fees are waived based upon the "Agreement on Student Exchange" between Akita University and the partner universities.		
Non-degree Study Students	¥14,800 per credit	¥28,200	¥9,800
Research Students	¥29,700 per month	¥84,600	¥9,800

*Annual tuition fee to be paid in two payments (one for each semester.)

*Government Sponsored International Students are waived from tuition/admission/examination fees.



Accommodation

Movies of Look around facilities



English Sub



Chinese Sub

1. Dormitory House for International Students

1 International House "A" and "B"

5-minute walk to the University

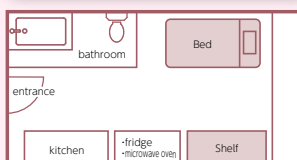

Boarding fee	(House A) Single occupancy rooms ¥5,900/month
	(House B) Single occupancy rooms ¥15,000/month
	*water, electricity and other living expenses not included
Maximum period of residence	1 year

Students' Voice

I am satisfied by daily life in the International House, because there are all facilities for a comfortable student's life. It is clean, new and the location is very convenient. Moreover, I can use a big lounge for teatime with my friends.

2 International Student House

15-minute walk to the University



Boarding fee	Single occupancy rooms: ¥5,900/month
	*water, electricity and other living expenses not included
Maximum period of residence	1 year

International Student House is Rent is inexpensive and the location is very good. There are lots of supermarkets around the dormitory and it is very convenient.

3 Nishiyachi Men's Dormitory

15-minute walk to the University

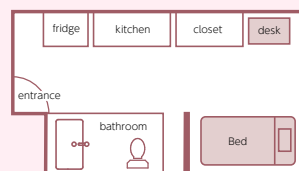

Dormitory house for both Japanese and international students. It is available until graduation. Boarding fee is ¥20,000/month.

Rough indication of monthly living expenses

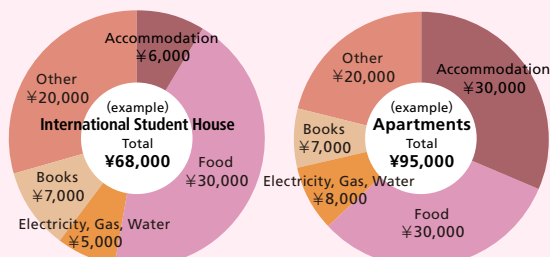

2. Private Apartments

Apartments are usually found through Akita University Co-op or local real estate agents. Rent varies depending on the area or age of the apartment but is generally approximately ¥30,000/month for a 6-jo studio apartment with a kitchen and bathroom. (1-jo = 180cm×90cm)

*2 or 3 months' rent as a deposit and / or "key money" may be required up front for signing a rental contract.

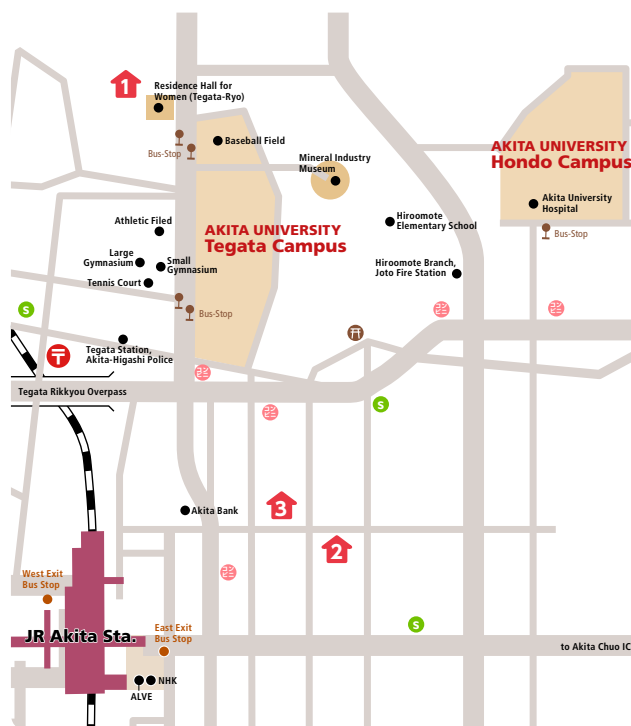

Convenience store Supermarket Postal Office



Message from Students



LEONG JIA ZE (Malaysia)

Faculty of Engineering Science
Department of Systems Design Engineering
Mechanical Engineering Course



Studying in Japan has been a dream of mine since junior high school, and now that dream has come true at Akita University. I attended a Japanese language school in Malaysia for a year and a half in order to study in Japan, and last year I took the entrance examination for Akita University under the "Pre-Arrival Admission" system. While waiting for the announcement of my acceptance, I continued to study Japanese and specialised subjects and acquired more knowledge.

This is the first time in my life that I have come to Japan, but I cannot believe that I was able to come to Akita alone. When I came to Akita, I didn't know any of my seniors in the country, so I was a bit worried,

but I managed to overcome the difficulties by myself and arrived at Akita University safely. I think this was a good experience and made me even more independent.

It has now been about three months since I lived as an international student at Akita University, and I have learnt a lot about Japanese culture and customs. I have been a little shocked at some of the cultural differences, such as using keigo (honorific language) and being aware of the relationship between seniors and juniors, but thanks to my seniors and classmates, I have been able to get used to life in Japan. When I first came to Akita, I lacked confidence and could not speak Japanese at all, but everyone listened to me slowly and talked to me, so I gradually gained confidence and became better at speaking.

There are many clubs and club activities at Akita University. I like music and I have joined the Light Music Society, and the people in the society are very kind and not only give me information about the society but also teach me about my studies. I am also glad that I have made many friends in the circle.

When I become a senior next year, I would like to tell the new international students about the warmth of Akita University. I want to introduce the beauty of Akita University to everyone.



PHOUNTONG KARN (Thailand)

Graduate School of International Resource Sciences
Earth Resource Science



Akita University is providing a lot of opportunities for my research that I have never experienced before. As a graduate student, the professors and staff will guide you throughout the research including the advice you needed and provide the laboratory facilities you can use to fulfill your research objective and get a degree. The research community here is even more interesting! You can make lots of new friends including Japanese and foreign students.

Aside from the research and the study, there are tons of chances to learn about Japan: cultures, language, sports, etc. The university will provide lots of activities for us to participate in events and let you learn about their lovely cultures at the same time. Akita city is also one of my favorite cities in Japan. The local people are nice and will warmly welcome you. The nature here is also very amazing. You can enjoy the beautiful nature in every season throughout the year.

To sum it up, if you are considering getting the world-class education, experiencing the Japanese culture and its beautiful scenery, and making new friends, Akita University is a perfect answer to you. Cheers!

Undergraduate Application (for self-funded international students)

Applicants must take the Examination for Japanese University Admission for International Students conducted by Japan Student Services Organization (JASSO) prior to submitting their application.

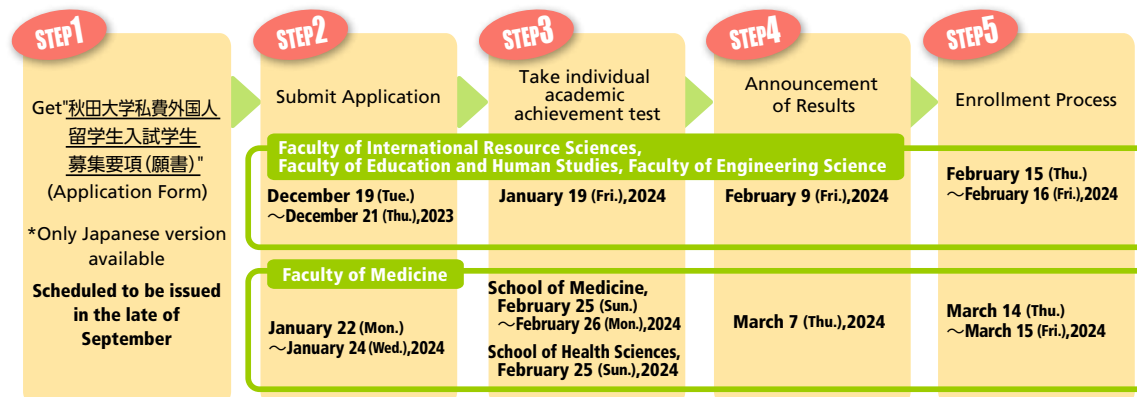

How to request the Application Form ("秋田大学私費外国人留学生入試学生募集要項")

*Only Japanese version available

Akita University Website for Applicants

<https://www.akita-u.ac.jp/eng/exam/>

Admission

Entrance Examination Guidelines

Student Application Guidelines
(Entrance Examinations for self-funded International Students)



Graduate School Application

Conditions and schedule for application vary between each graduate school. Please see the websites of each graduate school for information.

Graduate School of International Resource Sciences : <https://www.akita-u.ac.jp/shigen/graduate/info.html>

Graduate School of Medicine : <http://www.med.akita-u.ac.jp/departments/gs/kenkyu-selection.php>

Graduate School of Engineering Science : <https://www.riko.akita-u.ac.jp/graduate/prospectus/>

Access



From Tokyo

- Haneda Airport – Akita Airport (1hr 5mins)
- JR Tokyo Station – Akita Station (approx. 4hrs by Komachi, Akita Shinkansen)

From Nagoya

- Chubu Intl Airport – Akita Airport (approx. 1hr 25mins)

From Osaka

- Osaka Intl Airport (Itami) – Akita Airport (approx. 1hr 20mins)

From Sapporo

- New Chitose Airport – Akita Airport (55mins)



Akita University

Akita University Global Center for Higher Education

1-1 Tegatagakuen-machi, Akita City, Akita 010-8502

TEL+81-18-889-2258 FAX+81-18-889-3012

E-mail : ryugaku@jimu.akita-u.ac.jp

<https://www.akita-u.ac.jp/honbu/global/en/index.html>



Published in October 2023